

Rittling Steel Panel Radiator

PRV Piping Connections

"ETF" end trim

- Standard lengths 12" and 24"
- Required 3" min. overlap
- 1 tube to 10 tubes high

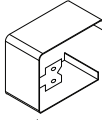

"ETFSB"
End trim support bracket
(2 pcs. per trim)

"CTF" center trim

- Standard lengths 12" and 24"
- Required 3" min. overlap
- 1 tube to 10 tubes high

1/2" NPT and 3/4" NPT connections

S = Supply

R = Return

V = Vent 1/8" NPT

D = Drain (optional)

"ELP" and "ELR" end cap trim

- 90° angle standard
- Standard lengths 12" and 24"
- Specify left or right (right side shown)
- Required 3" min. overlap
- 1 tube to 10 tubes high

C = Right side top

D = Right side bottom

E = Right bottom

F = Left bottom

G = Left side bottom

H = Left side top

"IC" inside corner trim

- 90° angle standard
- Standard lengths 6" x 6" and 12" x 12"
- Required 3" min. overlap
- 1 tube to 10 tubes high

PRV PIPING CONNECTIONS

Panel model	Depth	Style
PR	2"	Pedestal
PR and PRF	2"	Wall
PR2 and PR2F	3-3/8"	Pedestal
PR2 and PR2F	4-3/4"	Wall
PR3F	3-3/8"	Pedestal
PR3F	4-3/4"	Wall

Contractor _____

Architect _____

Engineer _____

Representative _____

Location _____

zehnder
Rittling

BUFFALO, NY USA

TITLE

ZR_PanRad_PRV_Piping_Connections

DRAWING NUMBER

April 1, 2012

Rittling Steel Panel Radiator

PRV-2

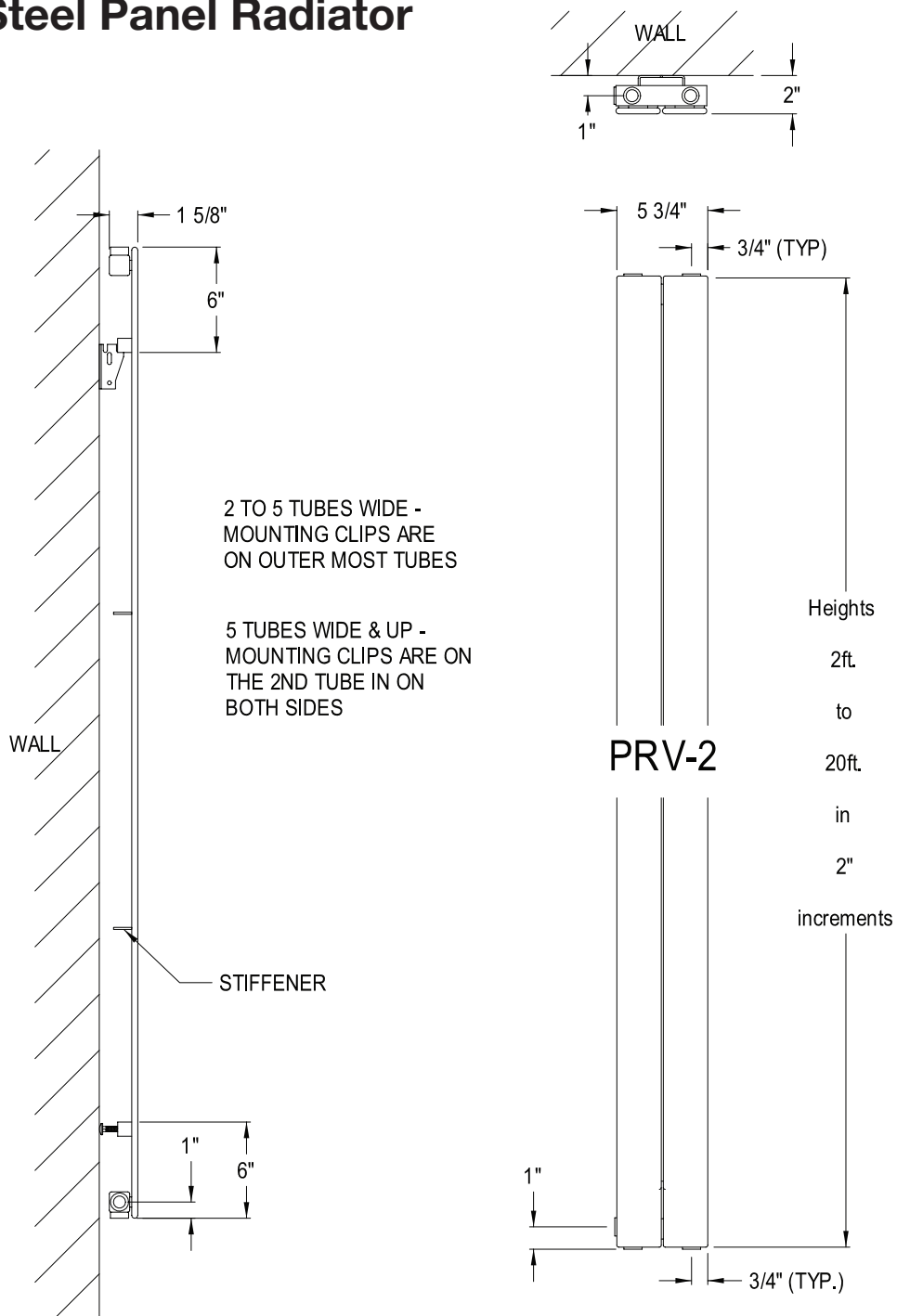

UNIT SHOWN WITH SIDE AND BOTTOM CONNECTIONS FOR DIMENSIONAL PURPOSES ONLY.
 PLEASE REFER TO PIPE CONNECTION SHEET FOR CONNECTION LOCATIONS AND SIZES OFFERED.

Contractor _____

Architect _____

Engineer _____

Representative _____

Location _____

zehnder
Rittling

BUFFALO, NY USA

TITLE

ZR_PanRad_PRV-2

DRAWING NUMBER

April 1, 2012

Rittling Steel Panel Radiator

PRV-3 to 10

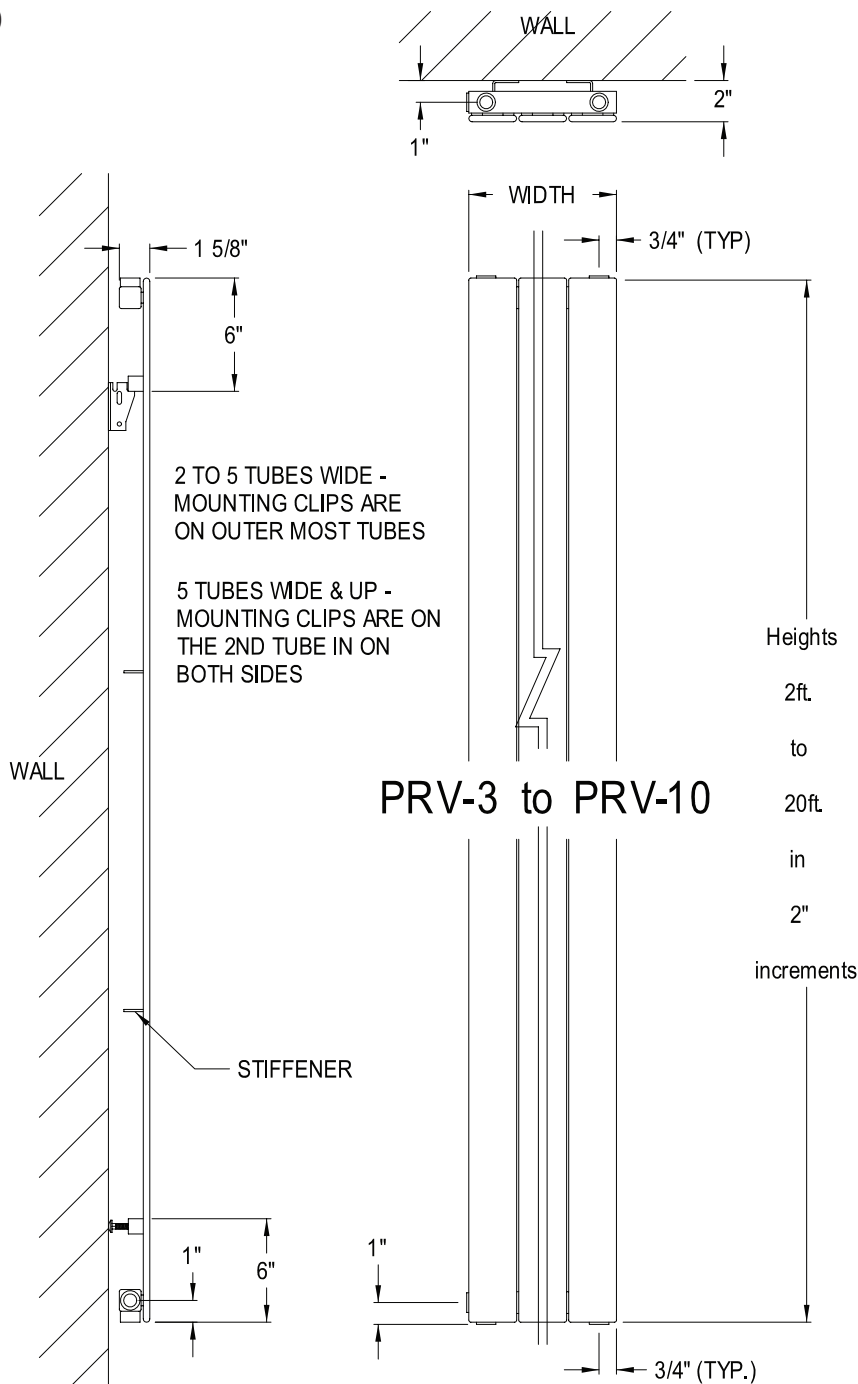

PRV-3 to PRV-10

Panel rows	Width
PRV-3	8-5/8"
PRV-4	11-1/2"
PRV-5	14-3/8"
PRV-6	17-1/4"
PRV-7	20-1/4"
PRV-8	23-1/8"
PRV-9	26-1/8"
PRV-10	29"

UNIT SHOWN WITH SIDE AND BOTTOM CONNECTIONS FOR DIMENSIONAL PURPOSES ONLY.
 PLEASE REFER TO PIPE CONNECTION SHEET FOR CONNECTION LOCATIONS AND SIZES OFFERED.

Contractor _____

Architect _____

Engineer _____

Representative _____

Location _____



BUFFALO, NY USA

TITLE

ZR_PanRad_PRV-3to10

DRAWING NUMBER

April 1, 2012